

INTEGRATED MASTER SHUT-OFF VALVE W/REGULATOR & FILTER

Installation Instructions



The 7212 and 7289 Integrated Master Shut-off Valves provide filtered, regulated air or water to the dental delivery unit. They are preset to 40 psi and ready to use for water, or if they are to be used for air, adjust the regulator to 80 psi.

Notes:

- The 7212 Integrated Master Shut-off Valve does not have a pressure gauge while the 7289 has a pressure gauge installed on the regulator.
- Ensure Manual Shut-Off Valves are turned off prior to installing the new valves.
- Tubing color codes described on these instructions apply to DCI manufactured units. On other units, identify the function of each tube then attach it to the proper connection.

Modify valve to use for air (See Figure 1)

Remove the plug closest to the filter housing and replace it with the 1/16" Barb and Washer (included). This will be used as the master air outlet.

INSTALLATION

See Figure 2 for master valve ports description

1. Install Integrated Master Shut-off Valve onto Manual Shut Off valves in the utility center. Use a 15/16" open end wrench to tighten the compression nut.
2. Attach clear tubing from Master On-Off toggle to the master air outlet barb on the Integrated Master Shut-off Valve for air.
3. Attach the yellow tubing from the Master On-Off toggle valve to the air signal inlet barb fitting on the plastic caps of the master valves. Typical installation uses two integrated Master Shut -Off Valves, one for air and one for water. Use a T-fitting to supply air signal to both air signal inlet bars.
4. Attach dental unit tubing to outlet ports to regulator of Integrated Master Shut-off Valve. DCI units have 1/4" and 1/8" yellow tubing to be connected to the air regulator. Tubing for water may be either blue or red and these will be connected to the water regulator.

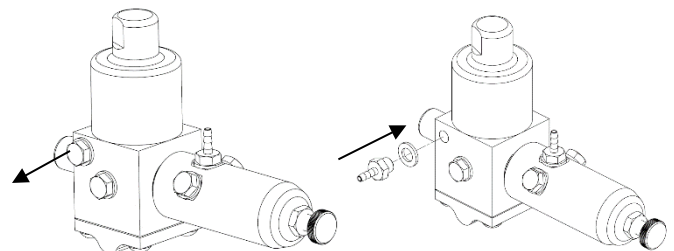

Figure 1 – Integrated Master Shut-off valve for use with air

Test the unit

1. Turn on the Manual Shut-off Valves.
2. Set the Master On-Off toggle valve to ON.
3. Check all tubing connections for leaks. If no leaks are observed, close the utility center and the unit is ready for use.

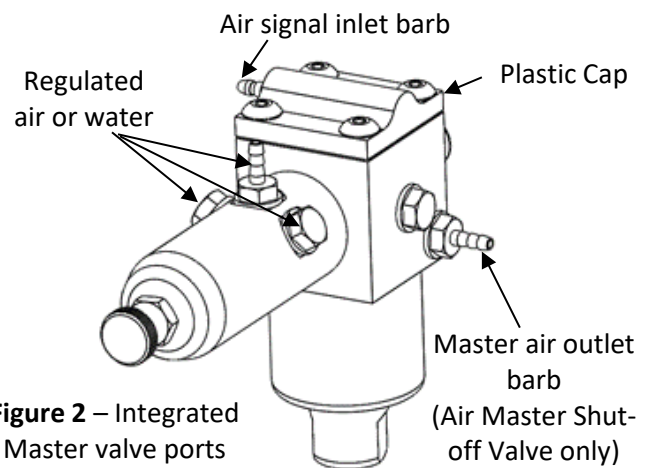

Figure 2 – Integrated Master valve ports description

